

SPARE PARTS

01.00 Air filter bag with quick fastener

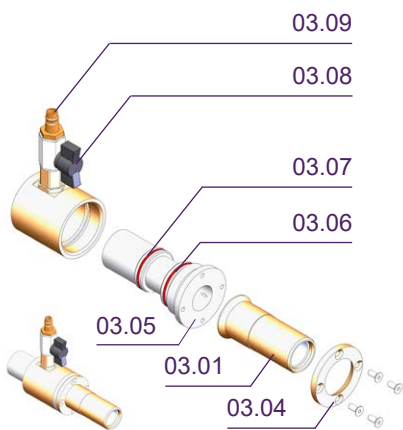
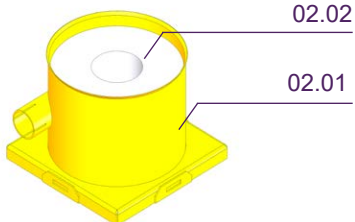

Flux Recovery Unit
(without suction nozzles)
.11.300.100.360.1

Pos. 01.00	Air filter bag, complete	Art. no.
01.01	Air filter bag dia. 185 mm	.10.161.220.2
01.02	Tightening strap with quick fastener	.10.504.583

Pos. 02.00	Collector bin with separator	Art. no.
02.01	Collector bin	.11.300.100Y370
02.02	Separator	.11.200.100.331

Pos. 03.00	Suction ejector	Art. no.
03.01	Clamping part w. ceramic tube (03.02+03.03)	.11.300.100.368.1
03.02	Clamping part	.11.300.100.368
03.03	Ceramic tube R 30 x 25 mm 80 mm long	.10.641.209
03.04	Clamping ring	.11.300.100.369
03.05	Suction nozzle piece	.11.300.100.366
03.06	O-ring 40 x 2 VMQ 70 Shore	.10.505.956
03.07	O-ring 36 x 2 VMQ 70 Shore	.10.505.946
03.08	Ball tap G3/8"	.10.163.772
03.09	Plug connection NW 7.2 G3/8"	.10.500.915



SPARE PARTS

SUBMERGED ARC WELDING

04.00 Suction hose

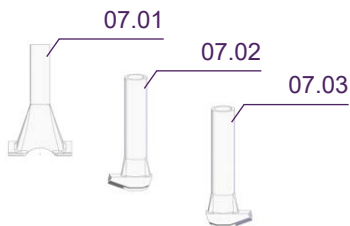
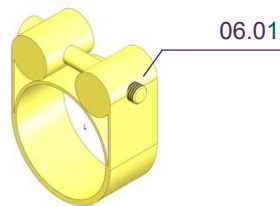
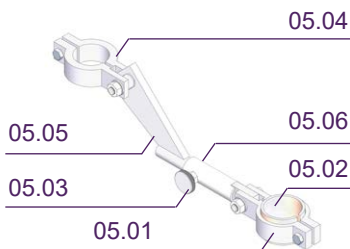

Pos. 04.00	Suction hose	Art. no.
04.01	Suction hose length 1.2 m (standard)	.11.200.100.345
04.02	Suction hose diam. 38 mm (per meter)	.10.575.0410

Pos. 05.00	Holder suction nozzles	Art. no.
05.01	Clamping sleeve dia. 44 mm	.11.300.100.363
05.02	Insulation bush dia. 38/43 mm	.11.200.100.337
05.03	Knurled screw	.10.267.310
05.04	Clamping sleeve dia 36 mm	.11.300.100.364
05.05	Connecting piece bolt	.11.300.100.386
05.06	Connecting piece mount	.11.300.100.389

Pos. 06.00	Hose clips	Art. no.
06.01	Hose clip for suction ejector	119.135.057
06.02	Hose clip for suction hose (2 piece)	119.135.048

Optional

Pos. 07.00	Suction nozzles	Art. no.
07.01	Suction nozzle butt weld	.10.575.075
07.02	Suction nozzle fillet weld, right	.11.300.104.339
07.03	Suction nozzle fillet weld, left	.11.300.104.340

www.kjellberg.de

Kjellberg Finsterwalde Schweißtechnik
und Verschleißschutzsysteme GmbH
Oscar-Kjellberg-Str. 18 | 03238 Finsterwalde

Copyright © 2022 Kjellberg | 09|03|23

+49 3531 500-800
welding@kjellberg.de